

FAA L-807 & L-807(L) WCH Series Rigid Wind Cones

Compliance and Applications

- ETL Certified L-807 & L-807(L): FAA AC 150/5345-27F
- ICAO Compliant to Annex 14, Vol. 1, para. 5.1.1 (Size 2)

L-807 wind cones provide visual indication of wind direction and velocity for pilots on airfields, heliports and vertiports. FAA Size 2 wind cones are used at the central location on the airfield. FAA Size 1 wind cones are used on smaller airfields and heliports.

Features

- Primary wind cone for airports, heliports and vertiports
- Pre-assembled bearings and one-piece welded aluminum basket for easy installation
- Center-hinged pole with easy-to-use winch for lowering basket
- Anchor cage for concrete footing included
- Available externally lighted, internally lighted, or unlighted
- 50,000 to 100,000 hour LED lamp life, virtually maintenance free
- LED lamps consume 80-90% less power than halogen lamps
- Night Vision Goggle (NVG) compatible obstruction light
- Solar Power Supply Option available; no more long underground wire and conduit installations
- Wind sock included, (berry compliant) treated for rot, mildew, and water repellent
- FAA Size 1 (18" dia. x 8') or FAA Size 2 (36" dia. x 12') sock
- Marine Treated Option (recommended for installations within 100 miles of saltwater) available for increased useful life in corrosive environments
- Powder coat painted international orange
- 4 year warranty on LED lamps, 2 year warranty on wind cone
- Designed to operate at any ambient temperature between -67°F (-55°C) and +131°F (+55°C)
- Designed to withstand winds up to 75 knots (86 mph or 140 km/hr)
- Windsock moves freely about the vertical shaft it is attached to when subjected to wind of 3 knots (3.5 mph or 5.6 km/hr) or more and indicates the true wind direction within $\pm 5^\circ$
- Windsock extends fully when subjected to wind of 15 knots (17.8 mph or 28.7 km/hr)



Intertek



External LED Light



Internal LED Light



Solar Power Supply (SPS) Option

A self-contained photovoltaic power source is now available for WCH Series wind cones (see page 4 for details).

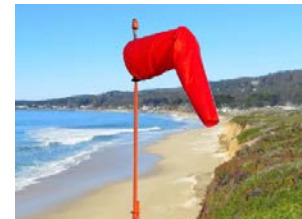

Marine Treated Option

Recommended for high salt and other corrosive environments. Includes: marine treated powder coat, stainless steel bearings, hardware, winch and anchor cage.



Ordering Codes

Catalog Number	See Notes	FAA Size	FAA Style	Power Source	Fixture VA	Fixture Watts	Weight (lb.)	Replacement Lamp
UNLIGHTED								
WCH-807-1-0-0-N		1	II Unlighted	None	0	0	187	None
WCH-807-2-0-0-N		2	II Unlighted	None	0	0	187	None
EXTERNALLY LIGHTED								
WCH-807-1-EX-120-5		1	I-A External	108-132 VAC	15	14	198	9200-0032
WCH-807-1-EX-230-5	1	1	I-A External	207-253 VAC	15	14	198	9200-0044
WCH-807-1-EX-66-5	2	1	I-A External	2.8-6.6 AMP	58	52	197	9200-0034
WCH-807-1-EX-12-5	3	1	I-A External	11.5-13 VDC	6	6	197	9200-0033
WCH-807-2-EX-120-5		2	I-A External	108-132 VAC	22	21	210	9200-0035
WCH-807-2-EX-230-5	1	2	I-A External	207-253 VAC	22	21	210	9200-0043
WCH-807-2-EX-66-5	2	2	I-A External	2.8-6.6 AMP	58	52	209	9200-0037
WCH-807-2-EX-12-5	3	2	I-A External	11.5-13 VDC	10	10	210	9200-0036
INTERNALLY LIGHTED								
WCH-807-1-IN-120-5		1	I-B Internal	108-132 VAC	32	19	200	9200-0038
WCH-807-1-IN-230-5	1	1	I-B Internal	198-265 VAC	40	21	200	9200-0045
WCH-807-1-IN-66-5	2	1	I-B Internal	2.8-6.6 AMP	72	65	198	9200-0039
WCH-807-1-IN-12-5	3	1	I-B Internal	11.5-13 VDC	6	6	197	9200-0041
WCH-807-2-IN-120-5		2	I-B Internal	108-132 VAC	60	32	212	9200-0040
WCH-807-2-IN-230-5	1	2	I-B Internal	198-265 VAC	76	36	212	9200-0046
WCH-807-2-IN-66-3	4	2	I-B Internal	2.8-6.6 AMP	95	88	210	9200-0031
WCH-807-2-IN-12-5	3	2	I-B Internal	11.5-13 VDC	10	10	210	9200-0042

Notes:

1. This model is not ETL certified.
2. Requires 100 watt L-830 transformer, sold separately.
3. Designed for use with Solar Power Supply or 12VDC Driver, sold separately
4. Requires 200 watt L-830 transformer, sold separately.
5. Wind cones come standard with center-hinged pole, anchor cage, orange wind sock and obstruction light. Add "-RW" for Red/White sock.
6. Power consumption specifications include the L-810 obstruction light.
7. Ships approximately 3 weeks after receipt of order.

Accessories

Part Number	Description
WS-AS1896	Spare Size 1 Wind Sock (18" dia. x 8'), Orange
WS-AS3612	Spare Size 2 Wind Sock (36" dia. x 12'), Orange
WCH-SPS*	Solar Power Supply for 12V wind cone models (see page 4 for details)

* Each SPS is custom configured for the proper solar panel, battery, temperature compensation and height for the installation location. Please contact Flight Light to configure the correct model for your location.

Shipping Information

- Unpackaged Weight: 187-212 lb.
- Palletized Volume: 72" x 48" x 42"
- Palletized Weight: 350 lb. (fully crated option 500 lb.)



*Included
Anchor Cage*



*Optional Spare
Size 1 Windsock*



*Optional Solar
Power Supply*

+1.800.806.3548 USA
+1.916.394.2800 Worldwide

www.flightlight.com
sales@flightlight.com

Flight Light Inc., 2708 47th Ave.
Sacramento, CA, 95822, USA

Dimensions

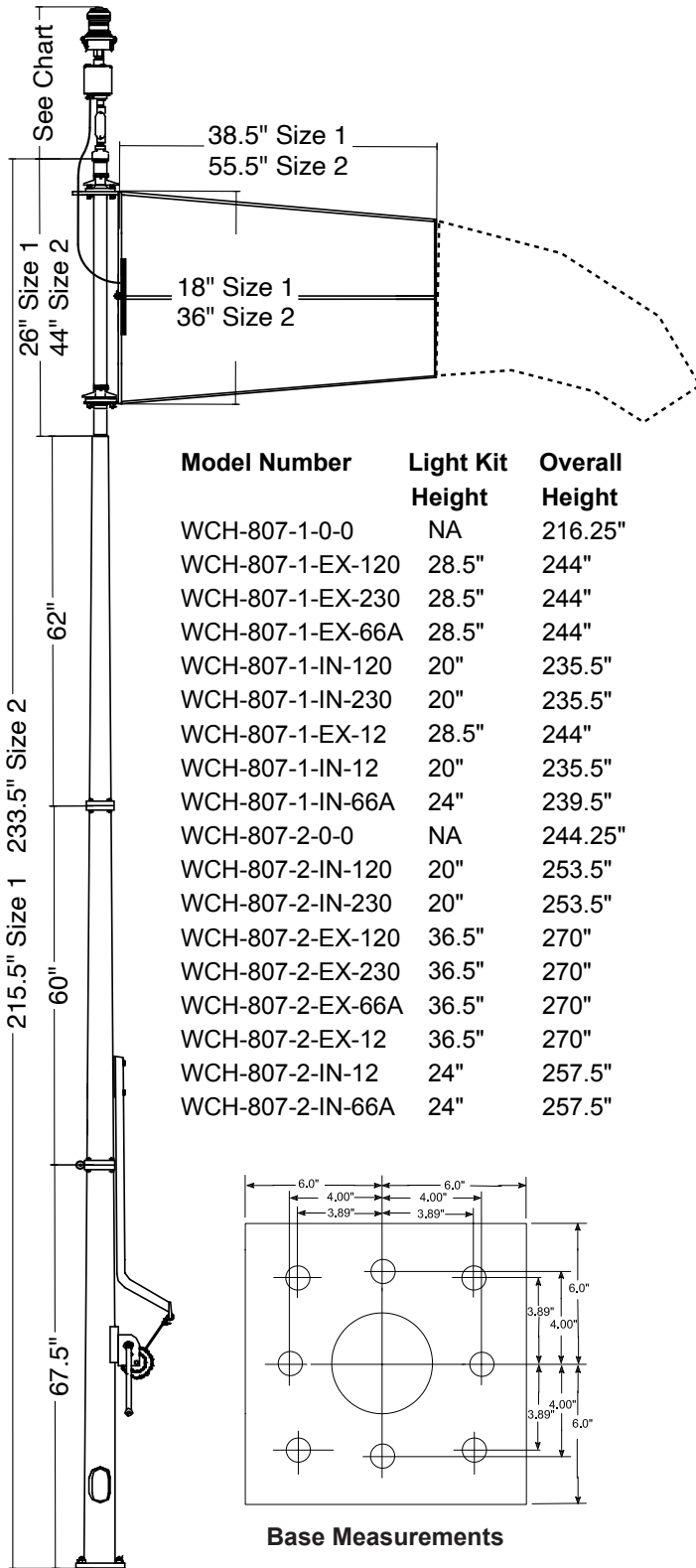

Anchor Cage & Footing

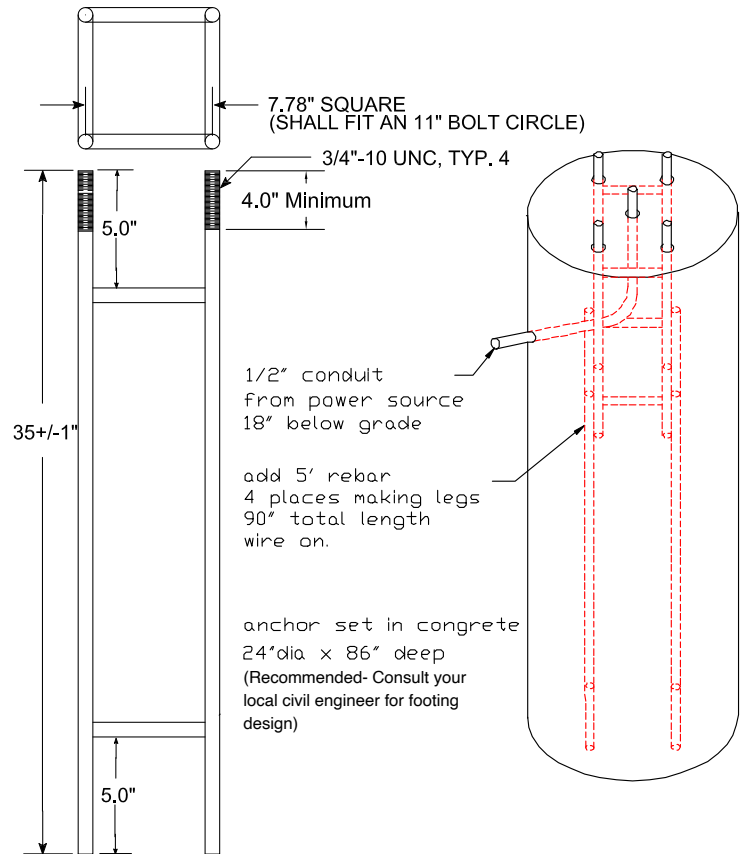

L807 Base Reactions:

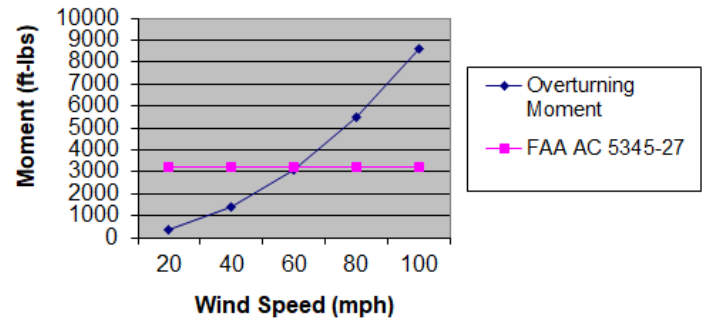

Wind Speed	Overturning Moment	FAA AC 5345-27
20	352	3200
40	1371	3200
60	3087	3200
80	5500	3200
100	8586	3200

WCH Series Wind Cone Solar Power Supply

Applications

The Solar Power Supply (SPS) is a self-contained photovoltaic power source for the WCH Series L-806 and L-807 wind cones.

Features

- Eliminates expensive underground trenching and wire installations for wind cones
- Easy installation: pre-set solar angle, pre-assembled anchor for easy mounting
- Fully sunlight powered, zero energy cost operation
- 10 day nominal battery autonomy
- Long life premium AGM solar batteries (5-10 years expectancy)
- 100 to 300 A-H AGM battery, designed for 4000 charge/discharge cycles
- 100 or 200 watt solar panel, with 12-year/90% and 25-year/80% power warranty
- Custom designed for the installation site, using 30-year worst case insolation and temperature extremes
- Insulated battery compartment to preserve battery life
- MPPT charge controller, with custom-programmed temperature compensation
- On-board indicators for battery, charging and system status
- Dual-post mount, with frangible couplings, designed to withstand ASCE Exposure C wind loads
- Temperature range: -49 to +131 °F (-45 to +55 °C)
- Marine treated option available for corrosive environments (upgrades enclosure to aluminum, stainless hardware throughout, marine treated powder coat)
- Manufactured in the USA

Installation Information

The SPS is attached to a 4-bolt anchor assembly (included), mounted in a concrete slab. Power is supplied to the wind cone by a cable in liquid-tight conduit through one of the SPS mounting legs.

Ordering Information

Product	Description
WCH-SPS-100-2-12	100 Watt Panel, 2 Batteries, 12" Legs
WCH-SPS-100-2-30	100 Watt Panel, 2 Batteries, 30" Legs
WCH-SPS-200-2-12	200 Watt Panel, 2 Batteries, 12" Legs
WCH-SPS-200-2-30	200 Watt Panel, 2 Batteries, 30" Legs
WCH-SPS MARINE	Marine treated option for installations within 100 miles of the sea. Aluminum enclosure, marine treated powder coat, stainless steel hardware throughout.

NOTE: Each SPS is custom configured for the proper solar panel, battery, temperature compensation and height for the installation location. Please contact Flight Light to configure the correct model for your location.



WCH-SPS

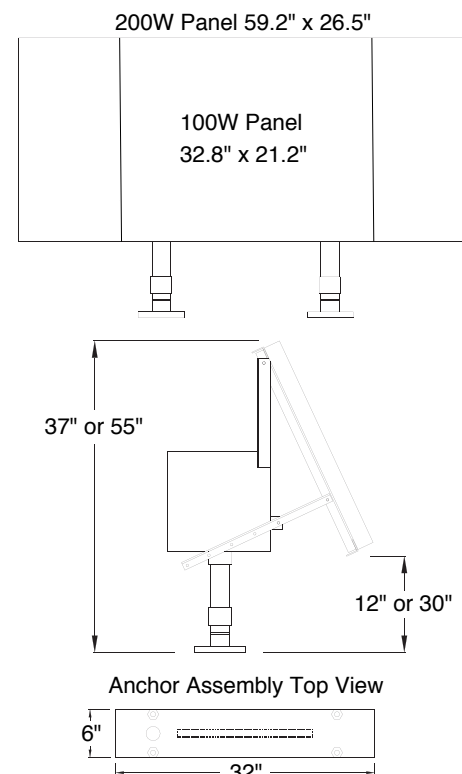

Replacement Parts

Part #	Description
WCH-7800-0004	Solar Panel, 100 Watt
WCH-7800-0005	Solar Panel, 200 Watt
WCH-1300-0081	Battery, PVX-840T
WCH-4500-0020	Charge Controller
WCH-7800-0006	Photocell
WCH-1800-0036	Frangible Coupling
WCH-2300-0024	Fuse, 10A 32V

Shipping Information

- Unpackaged Weight: 186-268 lb.
 - Shipping Weight: 266-388 lb.
 - International Shipping Weight: 466-588 lb.
 - Shipping Volume: 60" L x 40" W x 44" H
- Can be shipped with wind cone in same crate.